

SL5110	A	B	C	D	E	F	G
4-0 THRU 2-6	5"	5"	9"	3"	VARIABLES	VARIABLES	VARIABLES
2-4 THRU 2-0	4"	5"	9"	2	VARIABLES	VARIABLES	VARIABLES

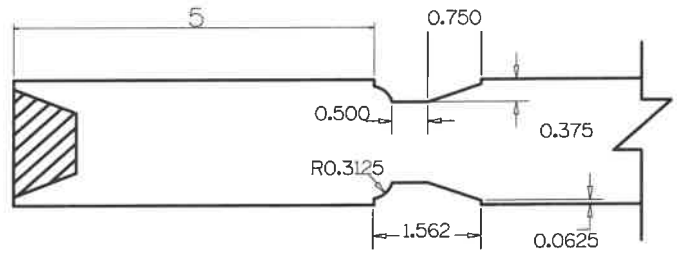

**Timberland**  
CUSTOM DOORS FOR A LIFETIME OF OPENINGS

Detail: STILELINE SL5110

Date: 8/11/22

Customer:

DWG#

By: IMN