

| SE9200 | A | B | C |
|---------------------|----|-------|----|
| 4-0 THRU 2-0 | 5" | 3/16" | 5" |
| 1-10 THRU 1-4 | 4" | 3/16" | 5" |
| 1-2 | 3" | 3/16" | 5" |
| 1-0 | 2" | 3/16" | 5" |

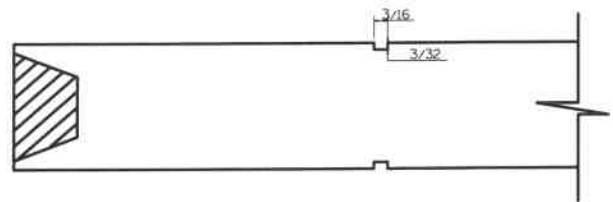

Timberland
CUSTOM DOORS FOR A LIFETIME OF OPENINGS

Detail: STILELINE SE9200

Date: 8/11/22

Customer:

DWG#

By: IMN